

AQUA-STAR HALOGEN LIGHTS FOR FIBREGLASS & VINYL POOLS

INSTALLATION INSTRUCTIONS

INSTALLER – READ ENTIRE INSTRUCTION SHEET BEFORE PROCEEDING TO INSTALL.

POOL OWNER – PLEASE KEEP THESE INSTRUCTIONS FOR FUTURE REFERENCE.

PLEASE NOTE
THESE INSTALLATION INSTRUCTIONS APPLY TO
AQUA-STAR HALOGEN LIGHTS FOR FIBREGLASS & VINYL POOLS ONLY.

Fibreglass and Vinyl Pools

Aqua-Star Halogen Pool Lights for Fibreglass and Vinyl Pools fit through a 4" (102mm) hole. The pool light is supplied fitted inside the fibreglass/vinyl housing. The housing is factory fitted with 1 metre of cable wound up inside. Supplied with lock nut and gaskets, ready to install. Stainless Steel Trim Ring Kits are available as an optional extra.

Included in the package are the following items:



AQUA-STAR HALOGEN POOL LIGHTS SPARE PARTS

CODE	ITEM	DESCRIPTION
ASL 054	19	NUT O-RING
ASL 102	20	GLOBE, 12V 50W
ASL 101	21	AQUA-STAR GLOBE HOLDER KIT INCLUDES GLOBE, LAMP-HOLDER AND O-RING
ASL 052	22	BODY, DIFFUSER & LOCK RING
ASL 070	23	BLUE LENS
ASL 071	23	GREEN LENS
ASL 074	23	CLEAR LENS
ASL 065	10	SCREW KIT (5/8" CSK)
ASL 255	25	STAINLESS STEEL TRIM RING KIT, AQUA-STAR FIBREGLASS INCLUDES BLUE AND GREEN LENSES AND 7/8" CSK SCREW KIT
ASL 272	13	LOCK NUT
ASL 123	14	CORK GASKET
ASL 124	15	RUBBER GASKET
ASL 252	16	CABLE GLAND
ASL 271	17	HOUSING - FIBREGLASS AND VINYL



Aqua-Star Halogen Flush Mounted Pool Light – Fibreglass & Vinyl Pools

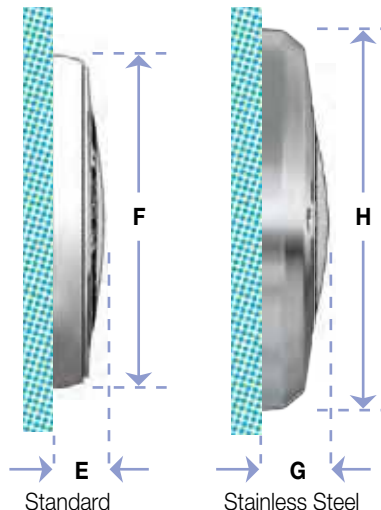
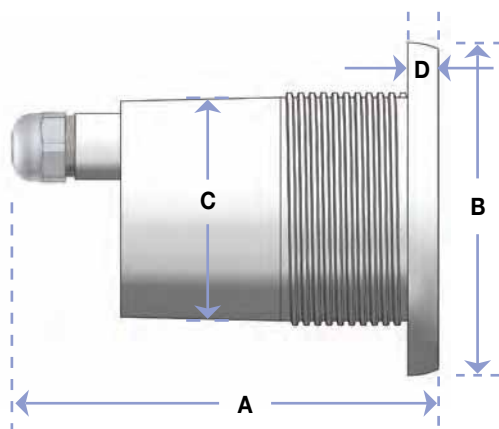

DIMENSIONS (mm)

A	195
B	144
C	100 max
D	13
E	23
F	144
G	25
H	167

AQUA-STAR HALOGEN INSTALLATION INSTRUCTIONS FOR FIBREGLASS & VINYL POOLS

- 1 Drill a 102mm (4") diameter hole in the pool wall where the light is to be located – the centre of the hole should not be more than 500mm below the top of the finished pool coping. Choose a flat surface. If pool is vinyl lined – first cut a similar hole in vinyl using knife before hole is cut through steel panel. Contact Aqua-Quip for suppliers of 102mm hole saws.
- 2 Remove any debris from around the hole cut. Feed the light cable through the hole in the pool wall, fit the pool light **Housing** into the hole, and push the white **Rubber Gasket** and **Housing** up against the pool wall. Apply a thin bead of waterproof silicone sealant between white rubber gasket and pool wall.
- 3 Behind the pool, pass the cable through the **Cork Gasket** and **Locking Ring** provided.
- 4 Fit the **Cork Gasket** over the thread on the rear of the **Housing** and push it up against the rear of pool wall.
- 5 Ensure the threads on the **Housing** and **Locking Ring** are clean of sand and debris.
- 6 Screw the **Locking Ring** onto the **Housing** and tighten it up against the **Cork Gasket** using a strap wrench or similar.
- 7 Use **Polished Stainless Steel Trim Ring** if required.
- 8 Only turn **Aqua-Star Halogen Pool Light** on when completely submerged under water.

TECHNICAL SPECIFICATIONS AQUA-STAR HALOGEN FLUSH MOUNTED POOL LIGHTS

Nominal Supply Voltage:	12V AC 50/60 Hz
Voltage Tolerance:	+2%, -10%
Protection Rating:	IPX8 (to 2.0m depth)
Temperature Range:	-10°C ~ +40°C water temperature
Power Consumption:	50VA
Rated Lamp Life:	2,000 hours
Light Output (typical):	900 Lumens

Aqua-Star Halogen Lights must only be operated underwater as they are water-cooled.

AQUA-STAR GLOBE CHANGING INSTRUCTIONS

- 1) Unscrew the 2 stainless steel screws, remove stainless steel trim ring and/or coloured lens if fitted.
- 2) Float the light to the surface and place on deck.
- 3) Grip the rear black nut with multi grips or use a screwdriver through the two holes in the black nut and ¼ turn anticlockwise whilst holding the white body of the light. This will remove the nut from the body, exposing the globe.
- 4) Remove existing globe by gently pulling the top of the reflector, do not pull on the glass. Replace the globe using a 12v 50w MR16 Globe, 55-60 degree beam. Never touch the glass when replacing the globe.
- 5) Replace and lubricate the nut o-ring. The replacement and lubrication of this o-ring is necessary any time the Aqua-Star light is disassembled. Only use silicone based lubricants.
- 6) If ceramic lamp holder is damaged or corroded, then it should be removed using long nosed pliers. The male spades of the new ceramic lamp holder will push into the female spades. Replacement ceramic lamp holders are available in kit form.
- 7) To re-insert nut into body. Place light body onto folded towel on ground with clear diffuser facing down. Align the mark on the nut with the alignment mark on the body, firmly push nut into body and ¼ turn clockwise.
- 8) Excess cable can be loosely wrapped around the body and/or inserted into the rear of the housing.
- 9) Remount the light (and coloured lens and stainless steel trim ring if fitted) to the dress ring using the 2 stainless screws. Fully submerge before operating.

ELECTRICAL CONNECTION AND OPERATION

- Install Light(s) and Transformer(s) in accordance with AS/NZS 3000:2007 as amended.
- Aqua-Quip's extra low voltage Transformers have either 2 or 4 secondary outputs, each being 12v 50VA, refer to Diagram 1.

TRANSFORMERS

Diagram 1 – Transformers

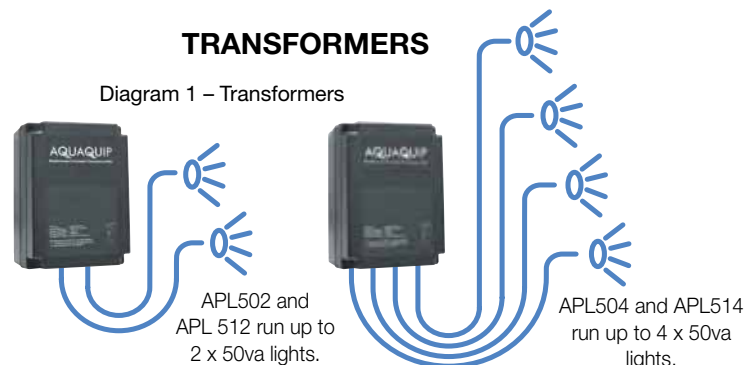

Rainbow Pool Products

PO Box 2388, Mansfield Qld 4122

Telephone STD 61-7-3849 5385

Facsimile STD 61-7-3849 5384

Email: info@rainbowpoolproducts.com.au

Web: www.rainbowpoolproducts.com.au